

1 INSTALLING THE BRACKETS

- All Solarglide venetian blinds are provided with size appropriate metal swing brackets
- Additional brackets will be needed the larger the width of the venetian blind, to provide adequate support
- Solarglide brackets are 'universal' which means they can be installed 'Top Fix' or 'Face Fix' into the window surrounds

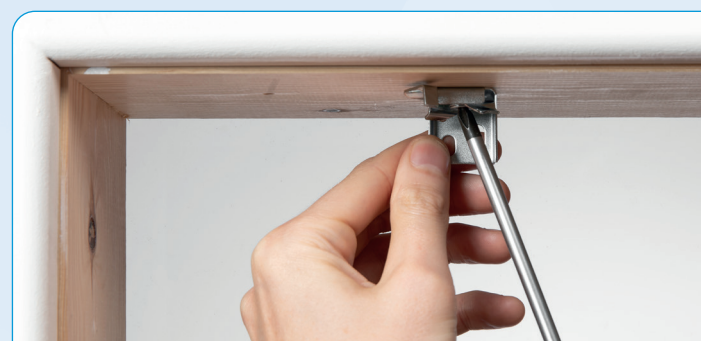

- A. Using one of the brackets as a template mark up the first hole with a pencil. Repeat this, taking into consideration that the brackets should be spaced out at equal intervals. Once all positions have been marked, drill holes in each position. If required, fit wall plugs.



- B. Carefully screw each bracket into place, ensuring they are aligned with one another in a straight row.

2 ATTACH THE VENETIAN BLIND TO THE MOUNTED BRACKETS

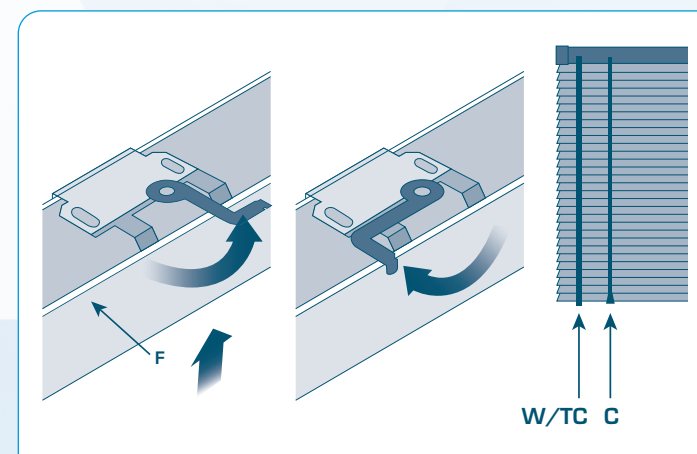

- A. Push the swinging arm of the bracket anti clockwise, rotating it as far as it will go. Clip the venetian blind over the installation bracket, first pushing the front lip of the headrail (F) into place before pushing the headrail up and back until its level.
- B. Holding the venetian blind headrail firmly, push the swinging arm clockwise so it rotates until it locks into place. If you need to remove the venetian blind, simple reverse the operation to release the headrail.
- C. To raise or lower the venetian blind, use the control cord (C). To Tilt and adjust the angle of the aluminium slats twist the wand or pull the tilt cords (W/TC).

3 INSTALL THE CORD ACCUMULATION DEVICE



WARNING Children can become strangled if this device is not installed. Always use this device to keep cords out of reach of children onboard

- A. The Cord Accumulation device shall be fitted as close to the headrail as possible and in all cases, no less than 1.5m from the floor
- B. To fit, mark the two holes and secure with the correct fixing into the wall or surrounds
- C. When the blind is raised ensure that any excess cord is stored onto this accumulation device. The cord should be accumulated by winding in a figure of eight motion as shown

On larger blinds two accumulation devices may be needed. If two accumulation devices are needed ensure they are at least 100mm apart and no less than 1.5m from the floor.

4 BREAKWAY CORD CONDENSER

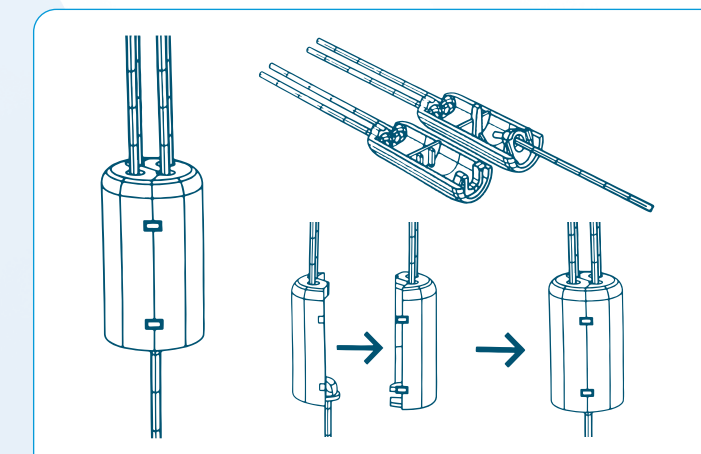

As an additional safety precaution all Solarglide venetian blinds are manufactured with a 'breakaway cord condenser'. They are pre-fitted to the blinds lift cord, and its aim is to eliminate any hazardous blind loops. The condenser should break apart with minimal force.

WARNING

Young children can be strangled by loops in pull cords, chains, tapes and inner cords that operate within venetian blinds. They can also wrap cords around their necks



- To avoid strangulation and entanglement keep cords out of reach of young children.
- Do not tie cords together. Make sure cords do not twist and create a loop.
- Solarglide venetian blinds are supplied with a 'cord break' safety device, however also ensure that the accumulation tie off device is installed for double protection.



CHILD SAFETY

If you have any further questions about child safety, please contact the Solarglide team at any time theteam@solarglide.com or +44 (0) 1915970543

OPERATING THE VENETIAN BLIND

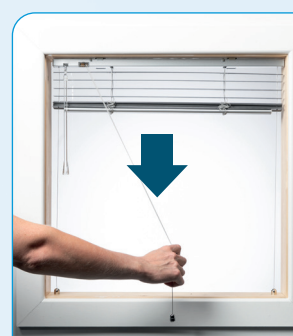

LOWERING

To unlock the cords, pull towards the centre of the blind and release gently through the hand until the required drop is reached. Lock the cord by pulling the cords to the outside of the blind to engage the cord lock.



RAISING

With slats fully open, pull the cords to the centre until the desired height is reached. Lock by pulling the cord to the outside.



TILTING

For aluminium venetian blinds rotate the clear wand clockwise or anti clockwise to tilt the slats to the angle of choice. For wooden and Faux Leather blinds simply pull the tilt cords up or down to tilt the slats.



MAINTENANCE

The slats can be kept dust free with the occasional wipe of a dry cloth. Alternatively a venetian blind slat brush can be used.